

ARSIMED MEDICAL

BT 24 - S

COMFYSIT BLOOD
TRANSFUSION CHAIR (4 MOTOR)

SERVICE MANUAL



PRODUCT INFORMATION THAT YOU NEED TO PROVIDE FOR SERVICING

DATE OF PURCHASE	
SERIAL NUMBER	
MODEL NUMBER	
NAME OF OWNER / FACILITY / DEPARTMENT	

If the table was purchased from an authorized Arsimed Medical dealer, please fill out the section below.

DEALER'S NAME	
DEALER'S PHONE NUMBER	
DEALER'S ADDRESS	

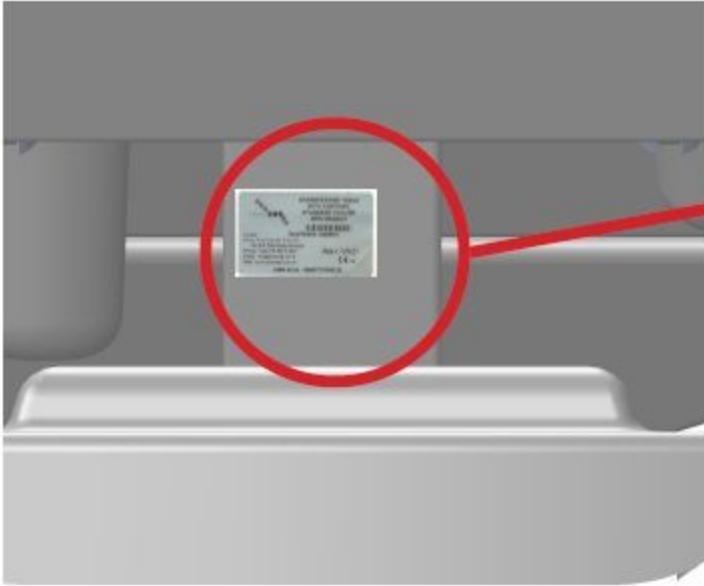

Serial Number

Arşimed Medikal Kozm.San.Tic.Ltd.Şti.

Tel: 00 90 216 567 8 567

Faks: 00 90 216 567 8 367

Web: www.arsimed.com.tr E-mail:
info@arsimed.com.tr

CHAPTER 1

INTRODUCTIO

NTypographical Conventions	5
Operating Precautions	6
Features	6
Technical Specifications	7
Electrical Description	8.
Product Symbol Definitions	9
table Components.....	10
Operating Instructions For OT03-S GYNAECOLOGY TABLE	11
Using The Handset.....	12
Entry Position	13
Trendelenburg position	14
Back Section Positioning	15
Table Height Positioning	16
Adjusting Headrest.....	17
table Dimensions	18
CHAPTER 2	
PART LIST and ASSEMBLY	19
Low Chassis	19
Leg Rest	20
Head Rest	21
Seat & Motor Compartment	22.
Back Rest	23.
Arm Rest	24

ELECTRICAL DESCRIPTION

Mains Power Requirements

Condition	Range
Rated voltage	110 V - 230 V
Power/input	6A / 2A
Frequency	50 Hz - 60 Hz

The electrical power system is insulated from the metal parts of the table. No additional electrical components, such as isolation transformers, are required to make this table meets applicable electrical codes.

All patient support surfaces are fully grounded through a three-wire power cord having a hospital-grade, 3-prong, grounded plug.

Each table is factory-tested for complete operation with and without a load.

Each table is tested for insulation integrity and micro-current leakage.

PRODUCT SYMBOL DEFINITIONS

Product Symbol Definitions







Symbol	Description
	Type B applied part according to EN 60601-1.
IPX4	IEC Standard publication 529
	CAUTION: Consult accompanying documents.
	Conforms to the European Medical Device Directive 93/42/EEC
	Alternative Current
	Direct Current
	Safe working load
	Protective Earthing Ground
	Keep feet clear of this area. Potential for injury.

TABLE COMPONENTS

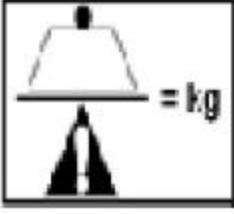

- 1) BACK
- 2) HEAD REST
- 3) NECK SUPPORT
- 4) LEG SUPPORT
- 5) SITTING PLACE
- 6) LEG SUPPORT FIXING ARM
- 7) SITTING PART ABS
- 8) ACTUATOR
- 9) LOWER PART ABS
- 10) CASTOR

OPERATION

1. Step Connect the power cable to in 100V-240V 50Hz/60Hz to turn on the table.

Make sure that power cable is connected into a compatible power source.

2. Step Make sure that the little green light on the handset is on.

If they are not on, please check the whether there is power. If the power is on and handset is off, perform troubleshooting.



Please make a risk assesment including the below prior to position the patient on the table :

- Risk of getting caught in the table (Hand, arm)
- Possibility to fall off the table
- Patients who have difficulty learning how to use the table
- Curious patients
- Little children
- Mentally handicapped patients
- Unauthorized people

When there is a situation where risk may occur, the tilting adjusting etc. functions should be locked (turned off).

USING THE HANDSET

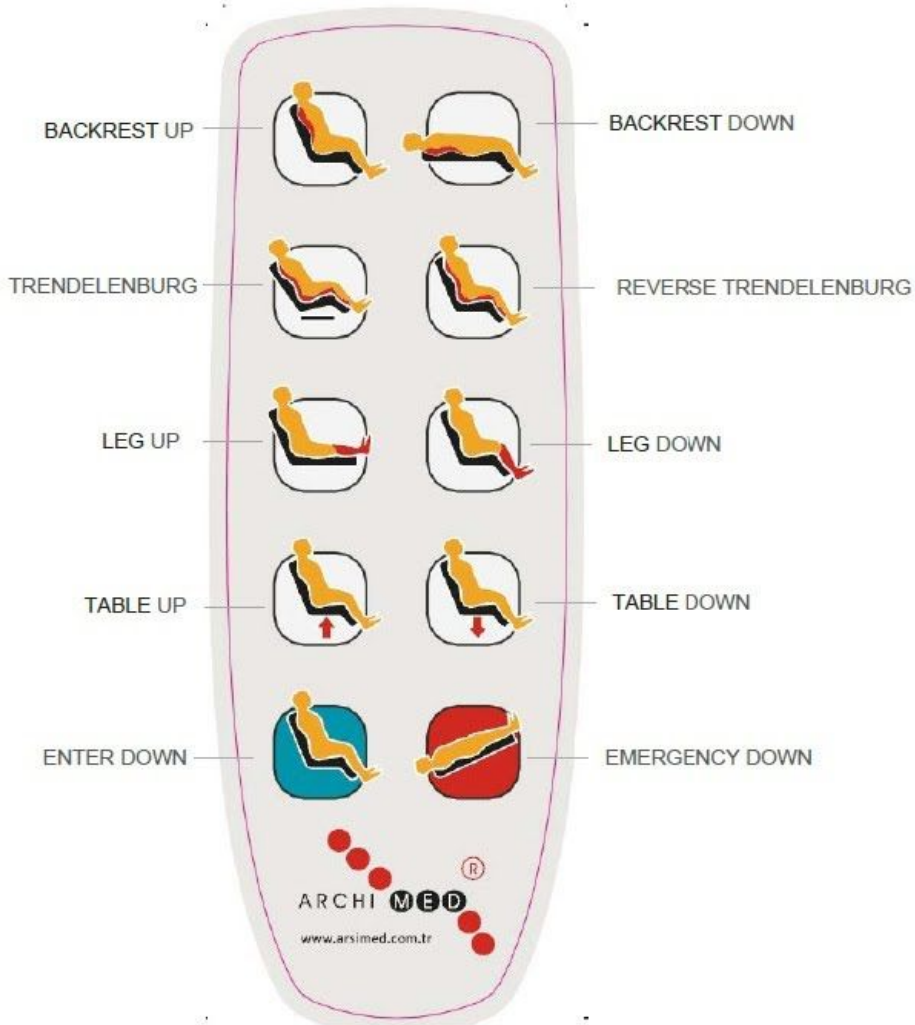

EQUIPMENT ALERT

The Back function will automatically stop moving when either the Up or Down travel limit is reached, but the actuator motor will continue to run.

Do not continue to operate a function that has reached its limit; this will cause the motor to overheat and may reduce the life of the actuator motor.

#	Function
1	When pressed, the back section raises
2	When pressed, the back section lowers
3	When pressed, the chair raises
4	When pressed, the chair lowers
5	When pressed, the chair takes reverse trendelenburg position.
6	When pressed, the chair takes trendelenburg position.

ENTRY POSITION

ENTRY POSITION



BACK SECTION POSITIONING

The back section can be positioned at any angle between horizontal and +78°.

To adjust the back section from a horizontal position to a table position, depress and hold the Back Up button (1) until the back section reaches the desired angle or the table position is achieved.

To adjust the back section from a table position to a horizontal position, depress and hold the Back Down button (2) until the back section reaches the desired angle or the horizontal position is achieved.

BACK SECTION POSITIONING



Before adjusting the table up or down, make sure that there is nothing (any accessories, objects, cables etc.) under the table. Failing to do so may result in injury or damage to the table.



When positioning the back rest. Look out for objects in the way. Do not let back rest touch objects while in motion. Beep will notify all personell of backrest motion. Should backrest hit an object, motor may break

TABLE HEIGHT POSITIONING

The table top can be positioned at any height between 23,79 – 31,88 in. (61 - 81 cm).

To raise the table top upward, depress and hold the table Up button (1) until the table top reaches the desired height or the maximum height is achieved.

To lower the table top downward, depress and hold the table Down button (2) until the table top reaches the desired height or the minimum height is achieved.

HIGH-LOW POSITIONING (table HEIGHT)

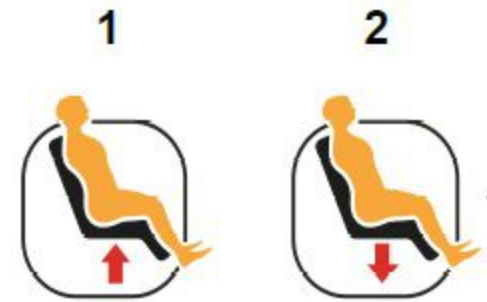

NOTE:

The table function will automatically stop moving when either the Up or Down travel limit is reached. Even if its button is depressed, the actuator will not continue to run (as the other actuator motors will). Sensors pre-vent the actuator motor from running when it has reached its Up or Down travel limit, thus preventing excessive wear of actuator due to full weight of table and patient.



Make absolutely certain that no objects (accessories, cable etc.) or person (especially children) are not under the table, and the arms and legs of the patient are not hanging down from the table before elevating or lowering the table. Failure to observe such safety rules may result in serious injury to the patients or damage the equipments.

TRENDELENBURG POSITION

Button for the chair to return to the Trendelenburg position.

TRENDELENBURG POSITION



Before adjusting the chair to trendelenburg position make sure that there is nothing (any accessorizes, objects, cables etc.) under the chair. Failing to do so may result in injury or damage to the chair.

Before bring the chair to trendelenburg position, ensure the safety of patients.

LEG SECTION POSITIONING

The back section can be positioned at any angle between horizontal and +85°.

To adjust the leg section from a horizontal position to a chair position, depress and hold the Back Up button (1) until the leg section reaches the desired angle or the chair position is achieved.

To adjust the leg section from a chair position to a horizontal position, depress and hold the Back Down button (2) until the leg section reaches the desired angle or the horizontal position is achieved.

LEG SECTION POSITIONING



Before adjusting the chair to trendelenburg position make sure that there is nothing (any accessories, objects, cables etc.) under the chair. Failing to do so may result in injury or damage to the chair.

Before bring the chair to trendelenburg position, ensure the safety of patients.

ASSEMBLING ARM REST

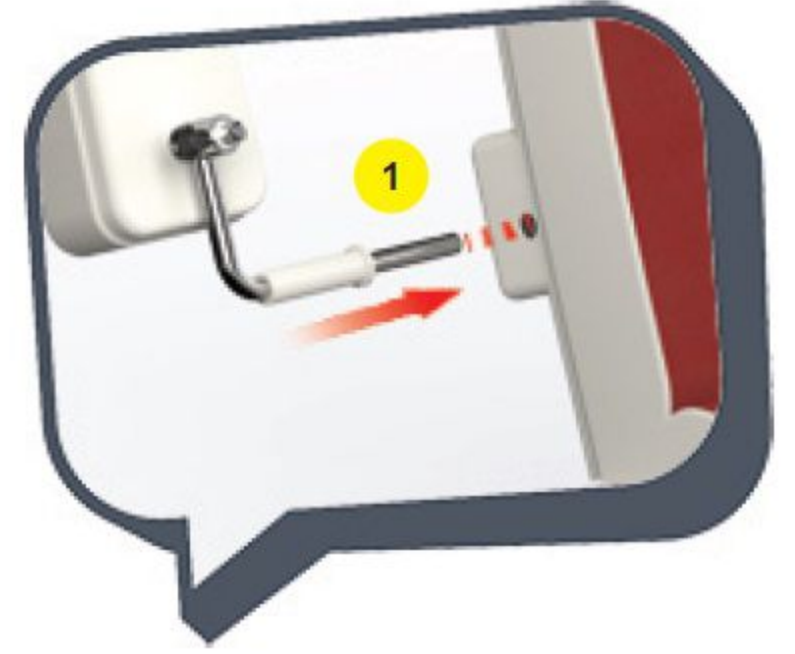

Kolçağı yere dik bir şekilde resimdeki (1) yuvaya oturtarak ,oturak yönünde (2) yatırarak montajı tamamlamış oluruz.

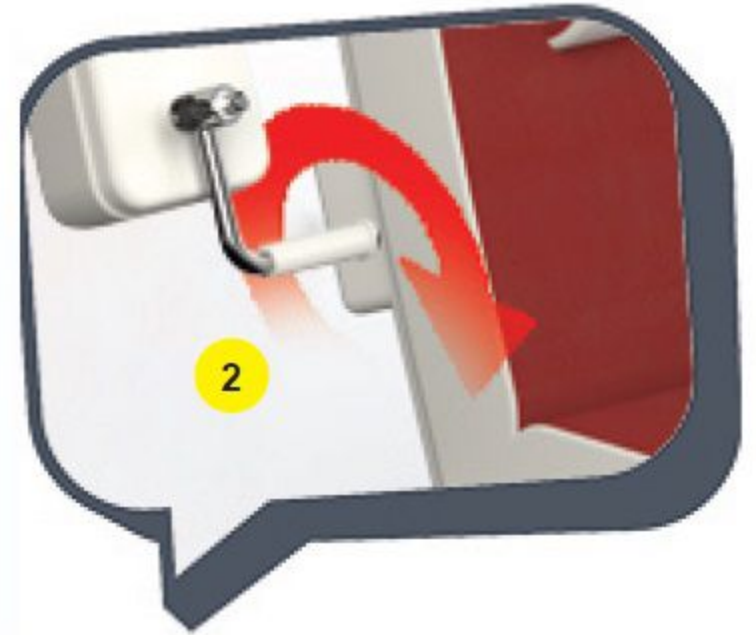

ADJUSTING HEAD REST

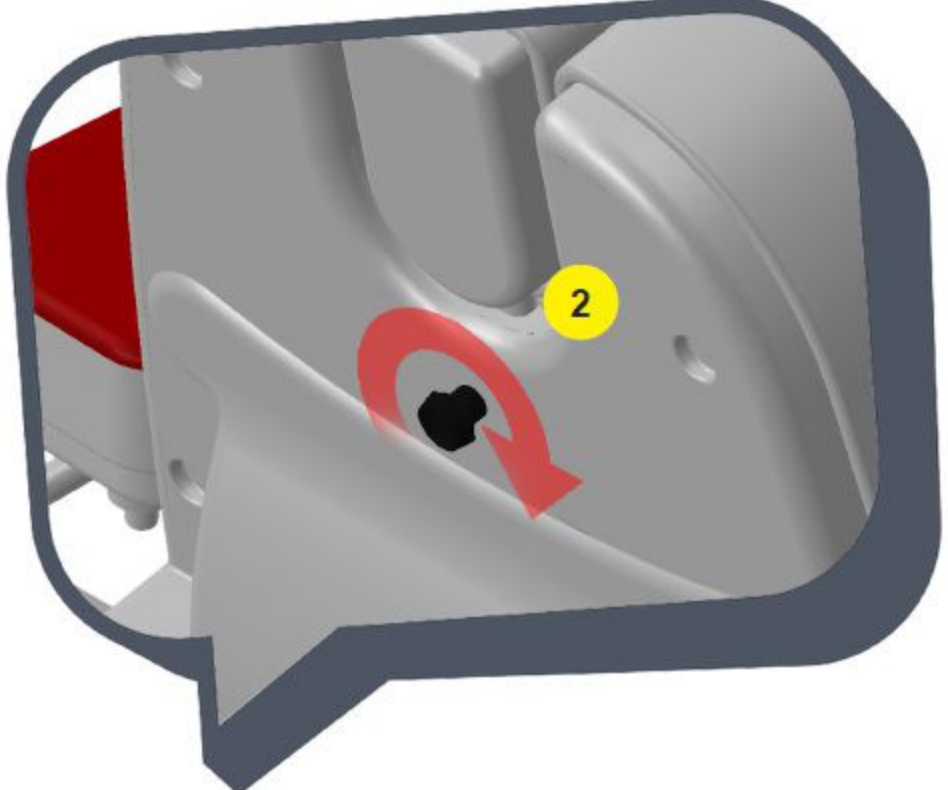
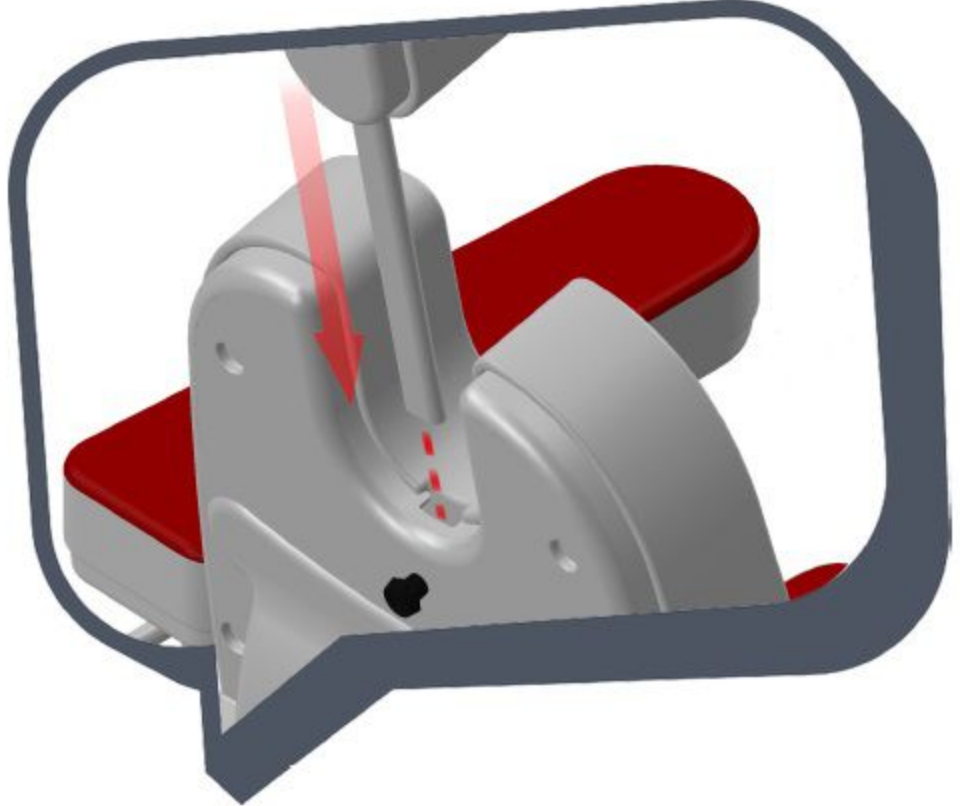

ADJUSTING ARM REST

Kolçağı (1) konumlandırmak için sabitleme kolunu (2) kullanarak yatay olarak hareketini sağlayabilirsiniz.

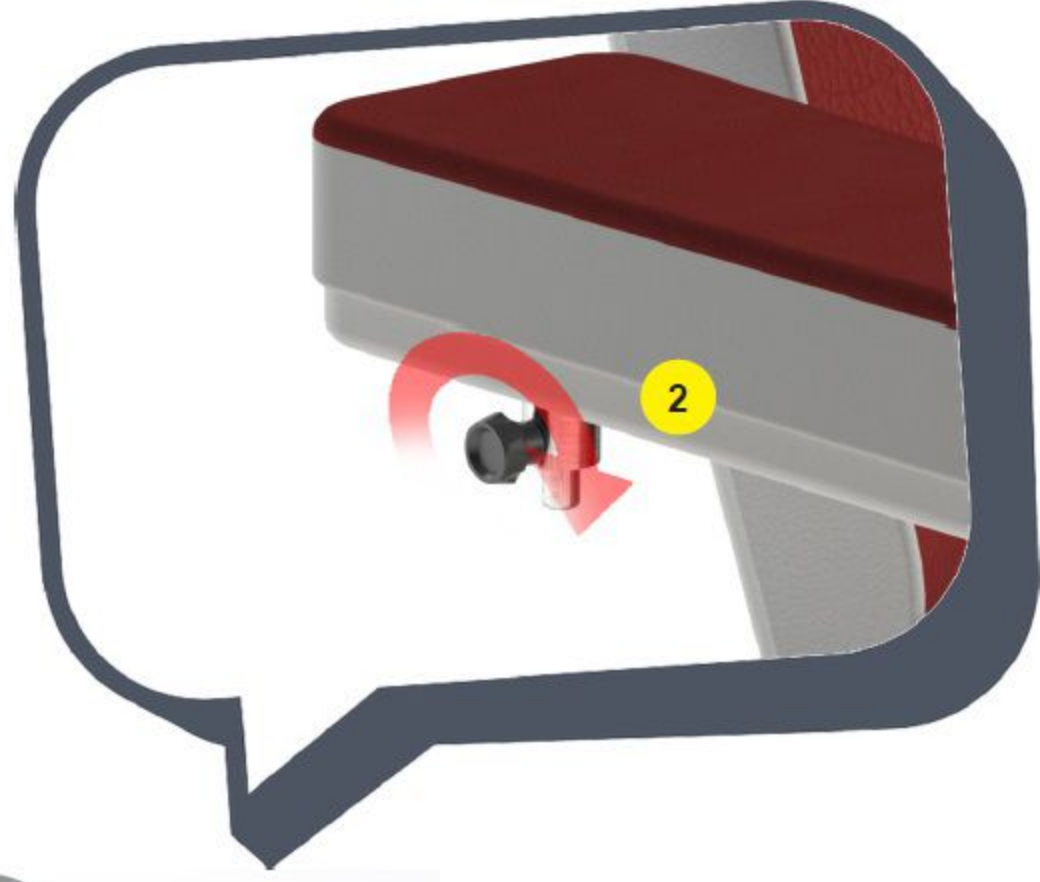

CHAPTER 3

CLEANING AND GENERAL MAINTENANCE



Cleaning and general maintenance procedures defined in this manual should be complied.



Do not expose the table to so much moist that liquid may accumulate. Otherwise, injuries to the people or damages to the equipment may occur.

Operating Instructions

- Disconnect the main power of the table.
- Clean the table with a soft, moist cloth and regular decontaminating agent. Do not use too much water.
- Dry the table thoroughly before re-using.

1. Light Soiling/Spills:

- ✓ Solution of 10% liquid soap with warm water applied with a soft damp cloth or bristle brush if necessary.
- ✓ Wipe away dry

2. Heavy Soiling/Spills:

- ✓ Dampen a soft white cloth with naphtha if available and rub gently.
- ✓ Rinse with a water-damped cloth.

3. More Difficult Stains:

- ✓ Dampen a soft cloth with 10% bleach (sodium hypochlorite) and 90% water -- Cavi wipes acceptable alternative.
- ✓ Rub gently.
- ✓ Rinse with water damped cloth, wipe dry.



For The Chairs With Batteries:

Never open a discharged battery, dispose of a discharged battery in fire, or have it contacted with water. A new battery should be installed only by an authorized person/technical staff. If the ARSIMED Medical EN14-S ARCHIMED E.N.T. CHAIR STANDARD COLUMN is currently in a warehouse – not in operation and supported by a battery, it should be charged in every 3 months to prevent any failure.



Don't use the high pressurized water, any of vaporized cleaning tool, and over 60 °C water.

CHAPTER 4

WHAT TO DO IN CASE OF A POWER CUT



For the tables With Batteries:

Never open a discharged battery, dispose of a discharged battery in fire, or have it contacted with water. A new battery should be installed only by an authorized person / technical staff. If the E.N.T. Chair is currently in a warehouse – not in operation and supported by a battery, it should be charged in every 3 months to prevent any failure.



When the table is being maintained or transported all the functions should be turned off. Otherwise, the table may be damaged or injuries may happen.



When the patient is left unattended and if the healthcare staff believes that he/she cannot operate the table safely, the functions of the table should be locked/turned off.



Improper operation may damage the table, and cause injury to patients or staff. Please consider following examples of improper use:

- Use of table for purposes other than general or intensive care
- Use of table in a pressurized room
- Operation of table by someone who has not read the instruction manual or who has not been trained
- Operation of the functions simultaneously by more than one person
- A weight of over 180 kg on the table
- Connecting to a power source other than the specified (220V 6A 50 Hz)
- Use of accessories other than the ones defined by the manufacturer
- Pull on the power cable while transporting the table
- Use of the table outdoors or in a vehicle
- Operation or storing of the table other than the specified methods
- Use of the table in an environment with explosion risk
- Moving the table on soft grounds or unsuitable surfaces
- Moving the table on slopes with an inclination of more than 10° C (with or without a patient)
- Using the table in an environment where any combustible gas or vapour is present
- Using the table at temperatures other than the specified temperatures

Any use which violates the terms specified in the user manual.

CHAPTER 5

UNPACKING AND MOVING THE TABLE

UNPACKING THE TABLE

Carefully remove the packing from the table and inspect the table and upholstery for any shipment related damage. If you detect any damage, contact us immediately. Please refer to page to for our contact details.



To avoid any damage to the table, do not use a knife or sharp object to open the chair's packaging and do not lift at the points shown as on the figure below.

MOVING THE TABLE

The table should only be handled and moved by professional personnel.



PATIENT POSITIONING

For a safe patient positioning, ensure the patient sits in the seat section



Do not sit on the leg or head section. It is not safe for the patient and for the chair, as injuries or chair damage will appear.

