

Sangofix® – Advanced Application of Blood and Blood Products

Hygienic and easy to use

1 PREPARATION OF APPLICATION AND BLOOD ADMINISTRATION SET



Gather general equipment such as Sangofix®, blood bag, Softa® Cloth, SwabCap®, Combi-Stopper, Omniflush® and a tray for disposal.

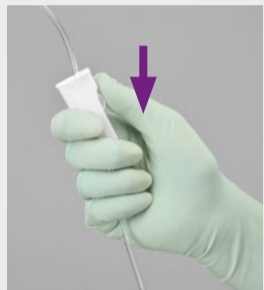

Close roller clamp.

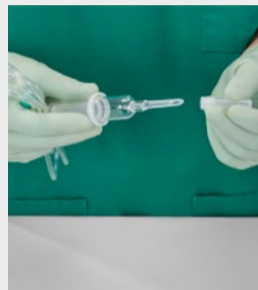

Remove protective cap from spike.



Insert spike into blood bag.* Use white ring as finger stopper.

* If necessary, disinfect blood bag port.

2 PRIMING OF BLOOD ADMINISTRATION SET



Hang blood bag on stand and attach patient connector to hook of roller clamp housing. Gently squeeze bottom part of the drip chamber and fill fluid level up to white ring.

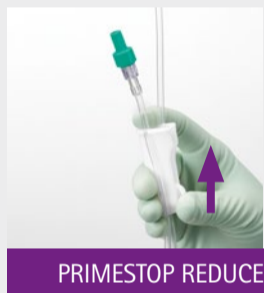

Open roller clamp and prime Sangofix® until free of air.

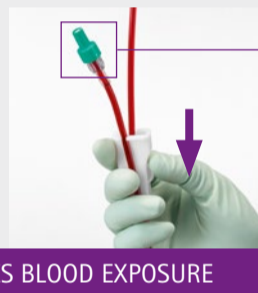

Close roller clamp.



Spin-Lock® Connector with PrimeStop

- Rotating collar of Spin-Lock® Connector prevents twisting of IV line during connection
- Protective cap lined with a hydrophobic, bacteria-tight membrane stops blood leaks while priming the set

3 PATIENT CONNECTION

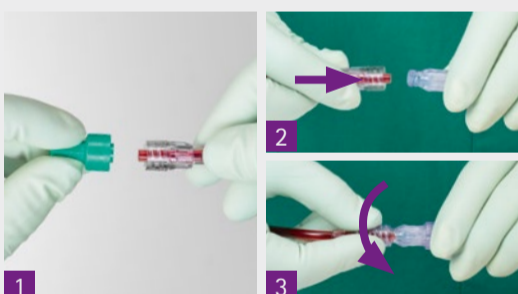

Remove PrimeStop cap. Then move collar of Spin-Lock® Connector backwards to activate its rotating function. Move collar forward and screw it clockwise onto the Caresite® extension set.

4 START BLOOD TRANSFUSION

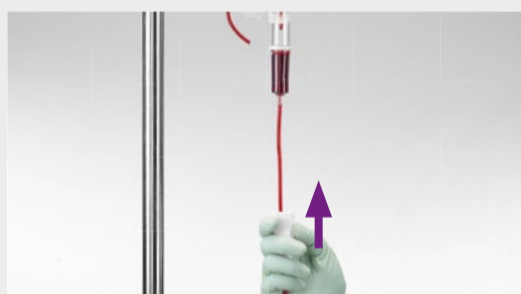

Open roller clamp and adjust flow rate.* Control drop rate during transfusion. To interrupt or stop transfusion, close roller clamp.

* With glass bottles and Sangofix® Air, open venting cap.

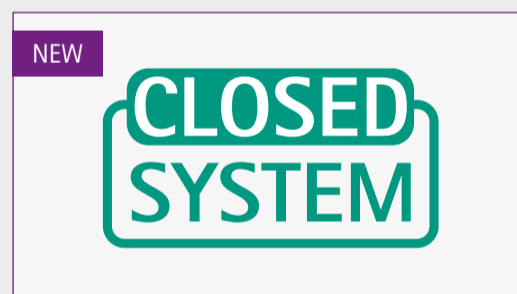

Closed System

The PrimeStop cap of Sangofix® prevents the escape of any solution or contaminants into the adjacent environment and is thus a closed system according to the NIOSH 2004 definition.²

5 DISCONNECTION

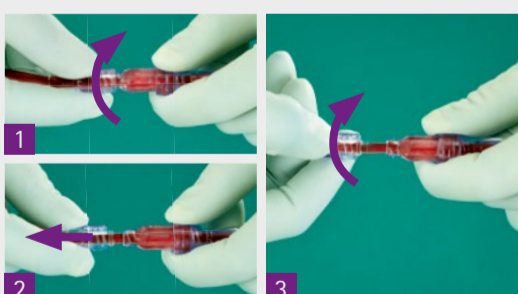

Unscrew the collar of Spin-Lock® Connector counter-clockwise. Then move collar backwards up to stop position. Turn collar counter-clockwise to disconnect from Caresite® extension set.

6 AFTER DISCONNECTION

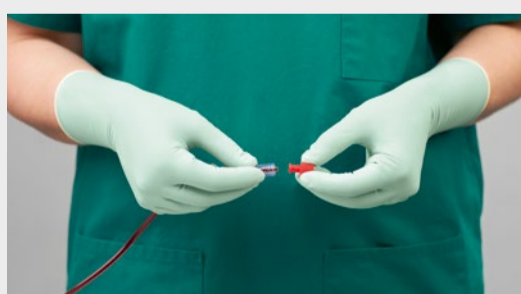

Close Sangofix® with Combi-Stopper. After termination of transfusion, container with remaining blood should be stored for 24 hrs at a temperature of between 2° and 8° Celcius.¹



Flush Caresite® extension line with Omniflush® and apply SwabCap® on Caresite® aseptically to provide continuous disinfection of valve surface plus a physical barrier to cross-contamination.