

## Attachments

Two patented\*\*\* attachments are included with the Veinlite LEDX:

- A. A snap-on light shield to reduce interference from bright overhead lighting.
- B. A snap-on pediatric adapter to reduce the size of the viewing area for use with infants.

The diagrams below indicate how to attach the light shield and neonatal adapter.

A. Veinlite LEDX Light Shield

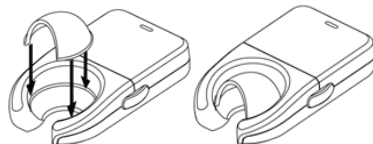

B. Veinlite LEDX Pediatric Adapter

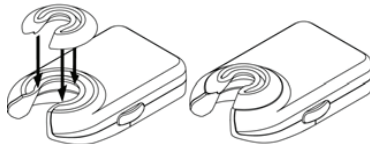

## Warnings

- Veinlite LEDX is designed for external examination only.
- To avoid contamination of the device, Veinlite LEDX must be used with the disposable plastic cover.
- To avoid the spread of infection, always change the disposable plastic cover between patients and wipe the new cover with a germicidal wipe.
- These devices are intended for use only by clinicians trained in performing vascular access, or under the supervision of a clinician.
- Do not look directly into the LEDs while on.

## Warranty Information

The Veinlite LEDX has a one year parts and labor warranty. Please provide the serial number located under the battery or the outside of the box when you contact TransLite LLC for any warranty issues. The warranty is valid only if the Veinlite LEDX is used according to the manufacturer's instructions. Before returning the Veinlite LEDX to TransLite for repair, you must call or e-mail TransLite to obtain a return authorization code and shipping information before sending your device. No refunds will be given for unauthorized shipping.

## Explanation of Symbols

SYMBOL	EXPLANATION
REF	Model Number
SN	Serial Number
	Manufacturer
EC REP	EC Representative (EU Only)
	Do not dispose as unsorted municipal waste.

EC	REP
----	-----

Healthcare & Education Centre  
The Church, Portland Street  
Southport, PR81HU, UK  
Tel: +44 1704 544 944  
Fax: +44 1704 544 050

This product is covered by Patents.  
Patent Numbers: 7,874,698; 7,841,751;  
8,032,205; 8,177,808

VLEDX DFU 6 1116



Manufacturer  
TransLite LLC

Tel: (281) 240 3111  
Fax: (281) 240 3122

www.veinlite.com  
info@veinlite.com



# Veinlite LEDX® CE

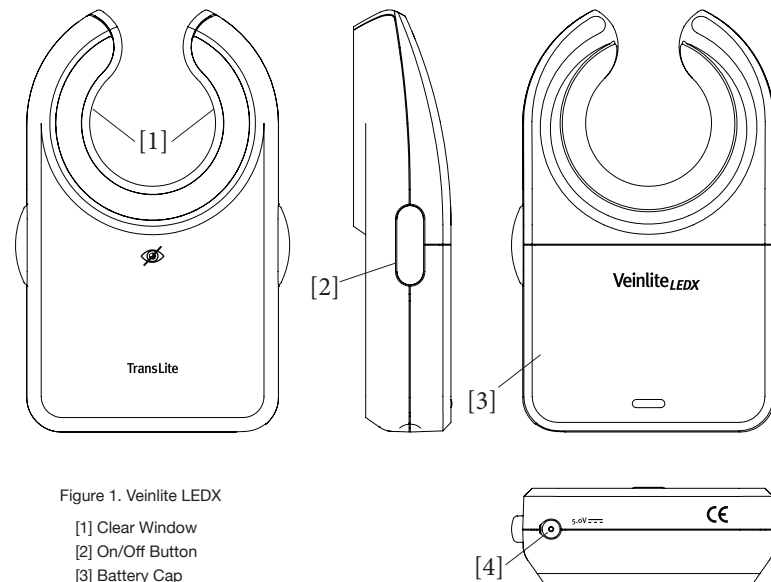

Figure 1. Veinlite LEDX

- [1] Clear Window
- [2] On/Off Button
- [3] Battery Cap
- [4] Charging Socket

## DIRECTIONS FOR USE

### Description

The Veinlite® LEDX is a hand-held battery powered transillumination device for visualizing veins and superficial blood vessels. It utilizes the patented\* transillumination technique known as side-transillumination, which enables the Veinlite LEDX to uniformly illuminate a small region of skin and subcutaneous tissue without any areas of shadow. The shadow-free side-transillumination technique allows better visualization of veins than any other transillumination method. The LEDs emit light with the optimal wavelength for highlighting the contrast between the venous blood vessels and surrounding tissue.

### Intended Use/Indications

- Venous access designed for sclerotherapy
- Improved visualization of veins in bariatric patients
- Specifically designed for phlebologists

### Contraindications

- When used for internal examination
- When used without the disposable plastic cover

## Operation

- Place the Veinlite LEDX against the patient's skin with the LED side in direct contact with the skin perpendicular to vein direction. Apply gentle pressure to maintain optimal skin contact.
- To turn on the LEDs, press the orange and/or the red button located on the left and right side of the device. Press the selected button(s) a second time to turn the LEDs off.
- Press the orange button if you are examining small superficial veins on fair skin.
- Press the red button to add the red color for examining deeper veins or if the patient's skin is darkly pigmented.

WARNING: DO NOT SHINE THE LED LIGHTS IN THE PATIENT'S EYES.

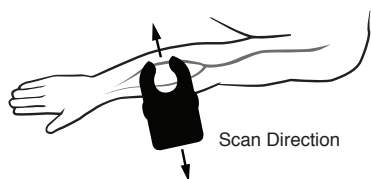

- 1 To scan for veins, place device against skin *perpendicular to vein direction*. Scan it forward and backward. Veins will be visible as dark lines due to transillumination.

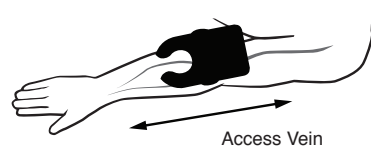

- 2 Once a suitable vein has been identified, rotate device 90°, parallel to vein.

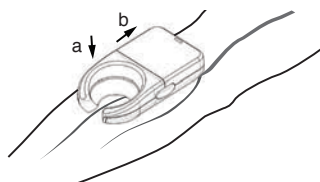

- 3a Apply gentle pressure on the Veinlite LEDX to secure the vein.
- 3b Push back slightly on the Veinlite LEDX to stretch the skin and provide traction.

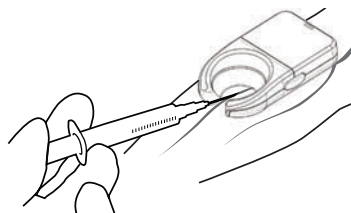

- 4 Insert the needle into the vein, through the opening of the device.

NOTE: Discard the single-use disposable plastic cover after each patient.

## Using the Disposable Plastic Cover

The single-use disposable plastic covers (Product #VLEDX-DPC) for the Veinlite LEDX **MUST** be used when the device is placed in contact with a patient's skin.

CAUTION: These plastic covers are not sterile. They should be wiped with a germicidal wipe prior to use.

- Before using Veinlite LEDX, place it inside the disposable cover with the flap on the same side as the LEDs.
- Pull the flap over the device to the other side.
- Wipe the LED side of the Veinlite LEDX and any part of it coming in contact with the patient, with a medically approved germicidal wipe.

## Precautions

- Avoid using alcohol on the clear plastic window as this may cause fogging.
- Do not immerse the device in liquid.
- Do not autoclave the device.

## Battery Level Indicator Light

Veinlite LEDX incorporates a low battery level indicator light. The orange button illuminates when the battery charge level has fallen to approximately 5% of the full battery charge.

## Recharging the Battery

The Veinlite LEDX is powered by a rechargeable lithium ion battery, which is designed to provide approximately between 130-160 minutes of continuous usage.

- Connect the charger to the Veinlite LEDX by inserting it into the charging socket located on the bottom of the device (see Figure 1.4).
- The orange button will blink indicating that the device is charging.
- Once the blinking stops your device is fully charged.

## Replacing the Battery

- Slide off the battery cover.
- Remove the battery by unplugging the connector at the top.
- Replace the battery with a new battery by plugging it into the connector
- Slide the battery cover back on.

NOTE: Before using your Veinlite LEDX, please read the detailed battery safety information on our website FAQ page: <https://www.veinlite.com/faq>.